

HC49S-SMD

Features

- high stability**
- low cost**
- tight tolerance**
- superb aging characteristic**
- excellent anti-shock holder**

Applications

- Cordless Phones
- Wireless Equipment
- Datacom Hubs / Switches / Routers
- ADSL Modems
- RF transmitters / receivers
- A/V applications

HC49S-SMD

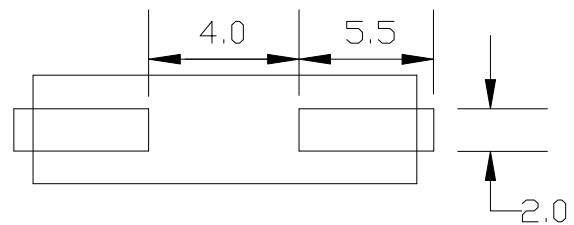
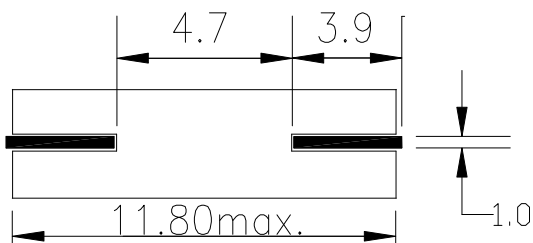
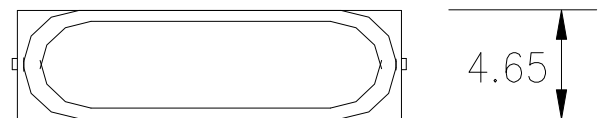
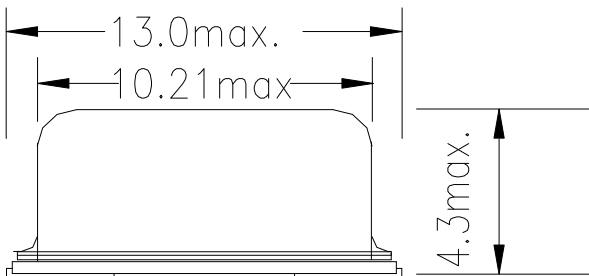

All dimensions are in millimeters.

Specifications

| | |
|-------------------------------|---|
| Vibration Mode: | fundamental / third overtone / fifth overtone |
| Frequency Tolerance at 25°C: | ±10ppm ~ ±50ppm |
| Loading Capacitance: | 10pF ~ 32pF or series |
| Shunt Capacitance: | 7.0pF max. |
| Equivalent Series Resistance: | see Resistance Table |
| Frequency vs. Operating Temp: | see Frequency vs Operating Temp Table |
| Drive Level: | 10 μ W ~ 1000 μ W |
| Insulation Resistance: | 500M Ω min / DC 100V |
| Storage Temperature Range: | -40°C ~ +85°C |

Resistance Table (ESR)

| Frequency Range(MHz): | HC-49U | HC-49T | HC-49S | HC49S-SMD | Vibration mode |
|-----------------------|--------|--------|--------|-----------|----------------|
| 1.800+ ~ 2.000 | 700 | 800 | 1200 | 1200 | fundamental |
| 2.000+ ~ 3.000 | 500 | 600 | 1000 | 1000 | fundamental |
| 3.000+ ~ 3.200 | 300 | 400 | 600 | 600 | fundamental |
| 3.200+ ~ 4.000 | 150 | 200 | 180 | 180 | fundamental |
| 4.000+ ~ 4.500 | 90 | 150 | 150 | 150 | fundamental |
| 4.500+ ~ 5.000 | 70 | 80 | 120 | 120 | fundamental |
| 5.000+ ~ 7.000 | 50 | 60 | 100 | 100 | fundamental |
| 7.000+ ~ 10.000 | 35 | 40 | 90 | 90 | fundamental |
| 10.000+ ~ 20.000 | 25 | 25 | 70 | 70 | fundamental |
| 20.000+ ~ 25.000 | 45 | 50 | 120 | 120 | third overtone |
| 25.000+ ~ 70.000 | 40 | 40 | 100 | 100 | third overtone |
| 70.000+ ~ 160.000 | 70 | 70 | - | - | fifth overtone |

Frequency vs Operating Temp Table

| Temp(°C) | PPM | ±2.5 | ±5 | ±10 | ±15 | ±20 | ±30 | ±50 |
|-----------|-----|------|----|-----|-----|-----|-----|-----|
| 0 ~ +50 | * | * | * | * | * | * | * | * |
| -10 ~ +60 | | | * | * | * | * | * | * |
| -20 ~ +70 | | | | * | * | * | * | * |
| -30 ~ +80 | | | | | * | * | * | * |
| -40 ~ +85 | | | | | | * | * | * |